

Modification of Development Consent

Section 4.55(1A) of the *Environmental Planning and Assessment Act 1979*

As delegate for the Minister for Planning, under delegation executed on 11 October 2017, I approve the modification of the development consent referred to in Schedule 1, subject to the conditions outlined in Schedule 2.



Chris Ritchie
Director
Industry Assessments

Sydney 29 MAY

2019

File: EF19/718

SCHEDULE 1

Application No:	SSD 5041
Applicant:	Sell and Parker Pty Ltd
Consent Authority:	Minister for Planning
Development:	Increasing the processing capacity of the existing metal recycling facility, including reconfiguration and expansion of the facility into the adjoining site at 23-43 Tattersall Road, Kings Park.
Date of Original Consent:	12 November 2015
Modification:	SSD 5041 MOD 3 – changes to plant including conversion of an existing shear, realignment of the overhead conveyor and relocation of the pre-shedder, increase in operational hours for cleaning and maintenance, and administrative changes for the discharge of wastewater.

SCHEDULE 2

This consent is modified as follows:

1. Insert the following definition in alphabetical order:

Modification Assessments

The document assessing the environmental impact of a proposed modification of this consent and any other information submitted with the following modification applications made under the EP&A Act:

- (a) Modification Application SSD 5041 MOD 1 and accompanying document titled *Statement of Environmental Effects 23-43 and 45 Tattersall Road, Kings Park* dated August 2016 prepared by Higgins Planning, additional information from Higgins Planning dated 22 December 2016 and further additional information from Allens and Linklaters dated 9 February 2017; and
- (b) Modification Application SSD 5041 MOD 2 and accompanying document titled *Statement of Environmental Effects 23-43 and 45 Tattersall Road, Kings Park* dated December 2017 prepared by Higgins Planning.
- (c) Modification Application SSD 5041 MOD 3 and accompanying document titled *Section 4.55(1A) Application (SSD 5041 – Mod 3), 23-43 and 45 Tattersall Road, Kings Park* dated 11 February 2019 and Response to Submissions dated 4 April 2019 prepared by Arcadis Australia Pacific Pty Ltd

In Schedule 2

2. Delete Condition A2 and replace with the following:

A2. The Applicant shall carry out the Development in accordance with the:

- (a) EIS prepared by ERM dated July 2014;
- (b) Response to Submissions report prepared by ERM dated 7 January 2015;
- (c) Supplementary Response to Submissions prepared by Mecone dated 30 June 2015;
- (d) Supplementary Response to Submissions prepared by Sell and Parker Pty Ltd dated 3 September 2015;
- (e) Modification Assessments
- (f) Site layout plans and drawings (See Appendix A);
- (g) Management and Mitigation Measures (see Appendix B);

3. Delete condition B6(e).

4. Delete condition B7(e)

5. Delete Condition B26 and replace with the following:

B26. The Applicant shall ensure that noise generated by the construction and/or operation of the Development does not exceed the noise criteria in Table 2.

Table 2: Noise criteria (dB(A))

Location	Noise criteria (dB(A))				
	Day	Evening	Night	Morning Shoulder	
	L _{Aeq} (15 minute)	L _{Aeq} (15 minute)	L _{Aeq} (15 minute)	L _{Aeq} (15 minute)	L _{Aeq} (1 minute)
189 Sunnyholt Road	46	46	38	46	58

6. Delete Condition B31 and replace with the following:

B31. The Applicant shall ensure that noise generated by the construction and/or operation of the Development does not exceed the noise criteria in Table 3.

Table 3: Hours of Construction and Operation

Activity		Day	Hours
Construction		Monday – Friday	7 am to 6 pm
		Saturday	8 am to 1 pm
		Sunday & Public Holidays	Nil
Operation	Oxy-acetylene torch cutting	Monday – Saturday	9 am to 3 pm
		Sunday & Public Holidays	Nil
	Cleaning and maintenance	Monday – Saturday	9pm to 6 am
		Sunday & Public Holidays	24 hours
	All other activities	Monday – Saturday	6 am to 9 pm
		Sunday & Public Holidays	Nil

7. Insert new Condition after B35C as follows:

B35D. Prior to the commencement of operation of the relocated pre-shredder the Applicant shall submit a Final Stockpile Plan to the satisfaction of the Secretary and FRNSW.

In the Appendices

8. Add new Site Plan to Appendix A.

APPENDIX A: SITE LAYOUT AND PLANS

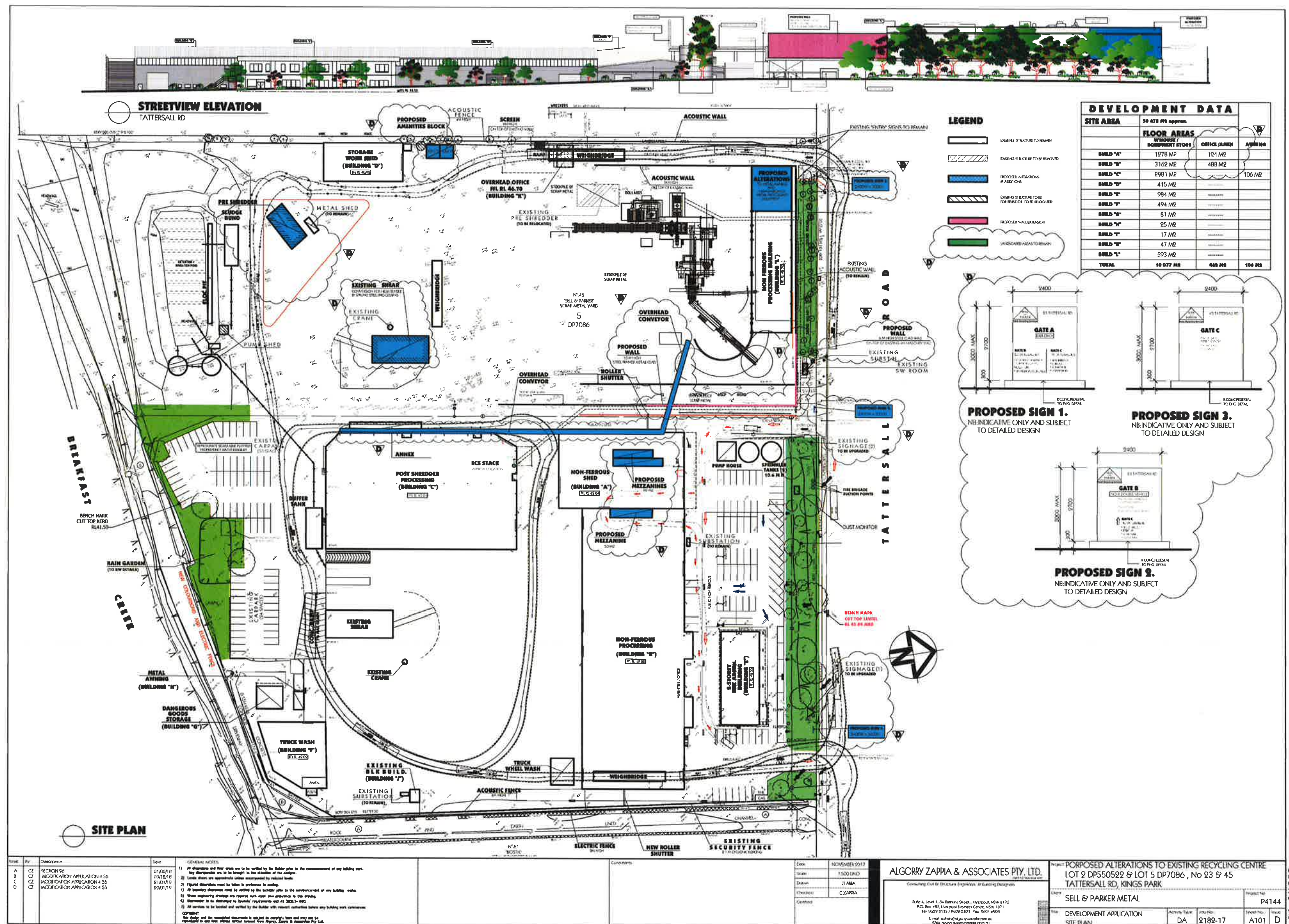

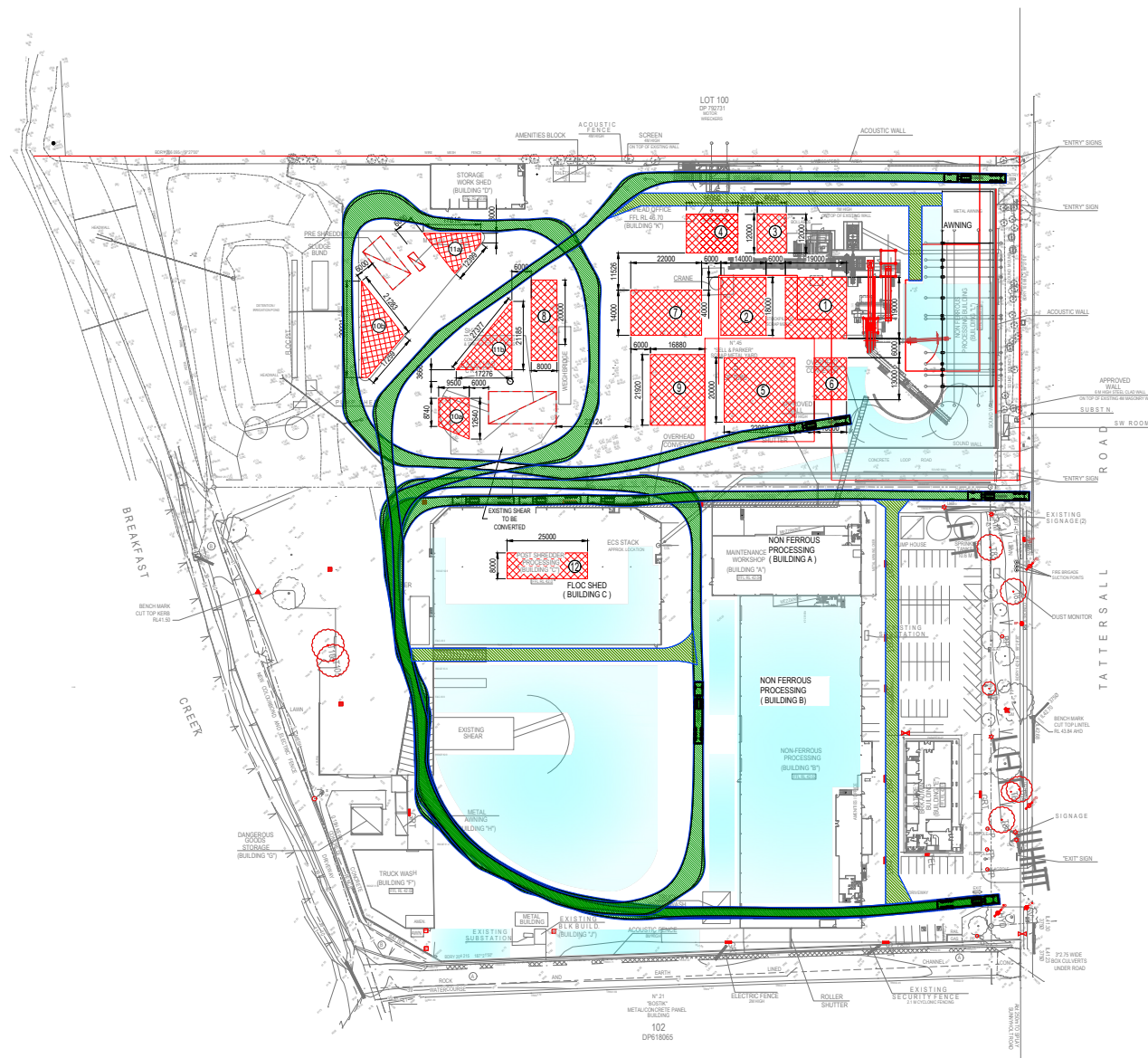

LEGEND	
	COMBUSTIBLE STOCKPILE
	STORAGE NON-COMBUSTIBLE MATERIAL
	ACCESS AND EGRESS ROUTES/ SWEEP PATHS

- NOTES
- MIN 0m ACCESS AROUND STOCK PILES
 - NOT ALL STOCK PILES WILL BE FULLY OPERATIONAL OR UTILIZED AT THE SAME TIME
 - DIMENSIONS INDICATED ARE APPROXIMATE ONLY
 - STOCK PILES TO BE FURTHER ASSESSED TO CURRENT FRNSW FIRE SAFETY GUIDELINES FOR WASTE FACILITIES VERSION 02/02 DATED 27 FEBRUARY 2020. STOCKPILE VOLUMES AND SEPARATION DISTANCES SHOWN ARE AS PER PREVIOUSLY APPROVED METHODOLOGY FROM FRNSW

PILE NO	TYPE	AVE HT (m)	SIZE (m3)	TONNES
1	INSPECTED SHREDDER FEED	4	1444	505
2	INSPECTED SHREDDER FEED	4	1008	353
3	INSPECTED SHREDDER FEED	4	576	202
4	AS DELIVERED SHREDDER FEED	4	624	218
5	AS DELIVERED SHREDDER FEED	4	1760	616
6	AS DELIVERED SHREDDER FEED	4	520	182
7	AS DELIVERED SHREDDER FEED	4	1288	451
8	AUTOMOTIVE	4	800	400
9	AUTOMOTIVE	4	1480	740
10a	PRE-SHREDDED AUTOMOTIVE	4	440	220
10b	PRE-SHREDDED AUTOMOTIVE	4	784	392
11a	PRE-SHREDDED AUTOMOTIVE	4	408	204
11b	PRE-SHREDDED AUTOMOTIVE	4	792	396
12	FLOC	3	600	200
TOTAL			12524	5079

DEVELOPMENT DATA		
SITE AREA	59,475 m²	
	FLOOR AREAS	
	WAREHOUSE	OFFICE/AMENITIES
BUILD 'A'	1278 m²	24 m²
BUILD 'B'	3162 m²	438 m²
BUILD 'C'	2981 m²	---
BUILD 'D'	415 m²	---
BUILD 'E'	984 m²	---
BUILD 'F'	494 m²	---
BUILD 'G'	81 m²	---
BUILD 'H'	25 m²	---
BUILD 'J'	17 m²	---
BUILD 'K'	47 m²	---
BUILD 'L'	593 m²	---
TOTAL	10,077 m²	462 m²

02	AMENDED ISSUE FOR LEC	JCR	-	-	28/7/21
01	ORIGINAL ISSUE	JCR	-	-	26/7/21
Issue	Description	By	Ckd	RPEU	Date

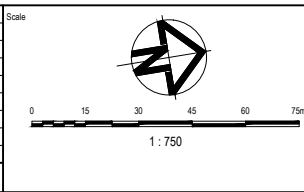

Surveyor	
Urban Designer	
Filename	

Client	

Status	
Approved	R.P.E.Q No :
Scales	1:750
Original Size	A1
Height	AHD
Grid	MGA

Project	SSD 5041 MOD 3 CONDITION B35D
Title	FINAL STOCKPILE PLAN APPROVED BY LEC PROCEEDING 2020/00365487